

**Tmatic** made in Germany  
H. Merkt · D-72160 Horb-Ihlingen  
phone +49 74 51/38 42  
fax +49 74 51/48 88

**INSTRUCTION 101**

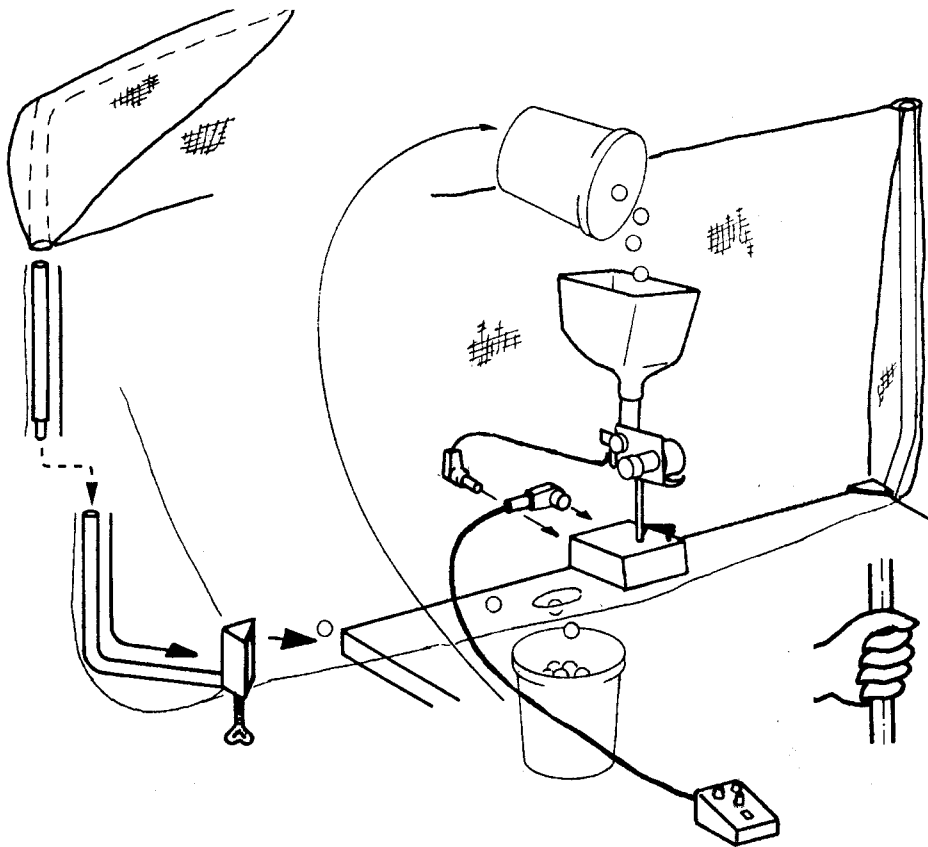
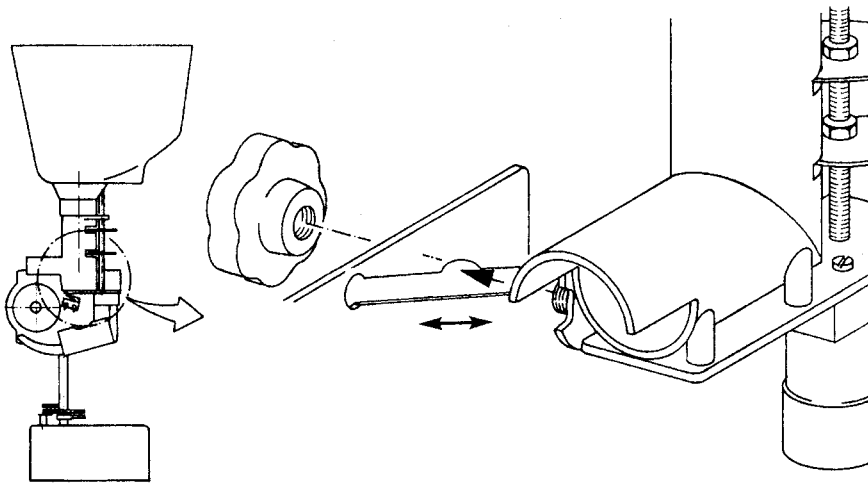

Put the net on the linkage as to keep the plastic foil inside.

The plugs should be put into the sockets

You should carry the machine by the stand.

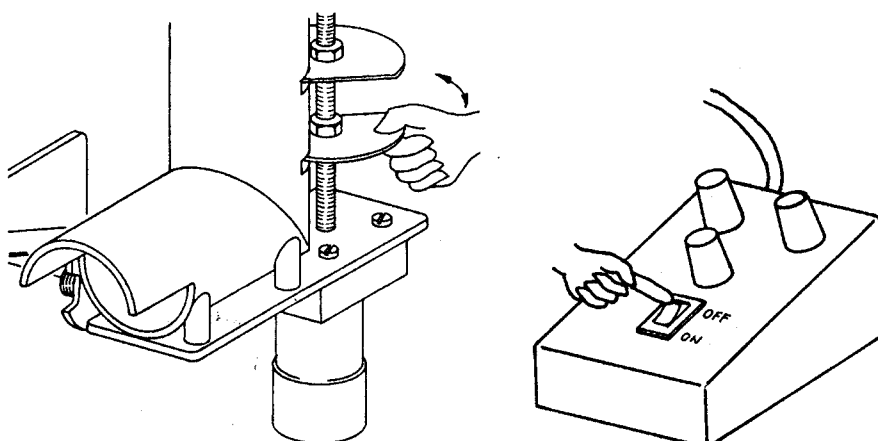

Should a ball be stuck in the transport system. - Switch off the machine.

Then you can carefully move the two plates by hand in the opposite direction, till the ball drops. If then the interruption is not yet removed, you should empty the ball container.

The reason could be a broken ball.

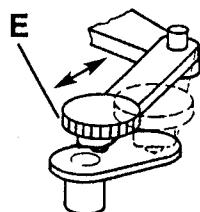
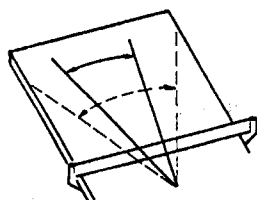
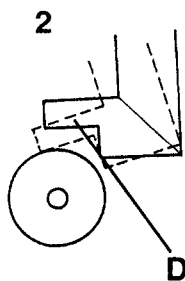
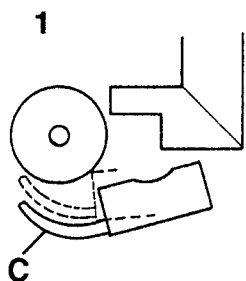
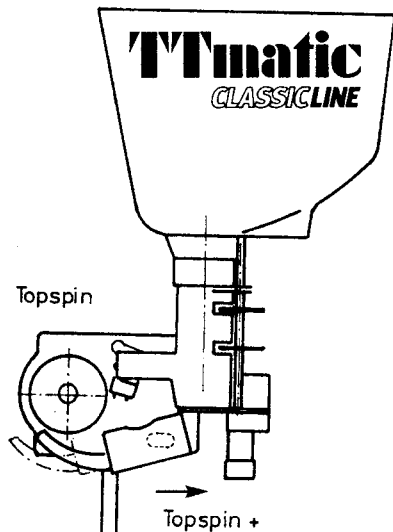
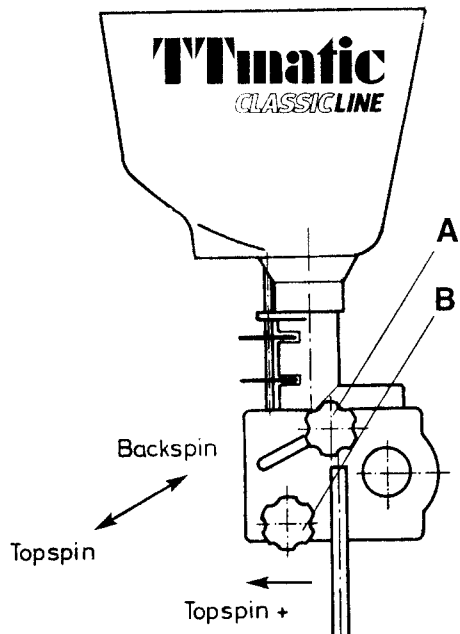

## ADJUSTMENT:

You can change the standards by first loosening and then fastening manually the nut A or B.

Principally the adjustment is easy. The nearer you get to the wheel with the ball-leading part C or D, the harder the ball comes out and the less it takes on spin. The same effect works the other way round: The more space there is between the leading part and the wheel, the softer the ball becomes. Thereby the spin becomes stronger, too.

If you increase the revolutions per minute of the wheel ( button for "speed") the ball gets even more spin; is the space between C or D and the wheel smaller, the ball becomes harder.

If the ball is too long or too short you have got more possibilities to regulate the distance: By changing button "speed" at the remote control board. By moving the machine backwards and forwards on the table.

## STANDARDS:

1. Topspin
2. Backspin

## OSCILLATOR:

By loosening the screw E and changing the holes you can push the lever axis inside or outside. Thereby you get a bigger or smaller swing radius.